

MATERIAL/FINISH PROPERTIES

MATERIAL PROPERTIES:
 BODY/SLEEVE/NUT: BERYLLIUM COPPER PER ASTM B196 OR EQUIVALENT
 BUSHING: BERYLLIUM COPPER PER ASTM B196 OR EQUIVALENT
 CONTACT: BERYLLIUM COPPER PER ASTM B196 OR EQUIVALENT
 INSULATOR: PTFE PER ASTM D1710 OR EQUIVALENT

PLATING PROPERTIES:
 BODY/SLEEVE/NUT: .000040 MIN. GOLD PER MIL-G-45204 OVER
 .000050 MIN. COPPER PER MIL-C-14550
 BUSHING: .000040 MIN. GOLD PER MIL-G-45204 OVER
 .000050 MIN. COPPER PER MIL-C-14550
 CONTACT: .000040 MIN. GOLD PER MIL-G-45204 OVER
 .000050 MIN. COPPER PER MIL-C-14550

MECHANICAL/ELECTRICAL PROPERTIES

CONNECTOR MEETS: MIL-STD-348 FIG. 310-1, MIL-PRF-39012
 CONNECTOR MEETS: RoHS 3 2015/863/EU STANDARDS
 CONNECTOR DURABILITY: 250 CYCLES MIN.
 CABLE: .047" SEMI RIGID
 CABLE RETENTION FORCE MIN: 22LBS [10KG] (ST/STEEL)
 11LBS [5KG] (NbTi)

ASSEMBLY INSTRUCTIONS: AI572
 IMPEDANCE: 50 OHMS NOMINAL
 FREQUENCY RANGE: DC-18 GHz
 VOLTAGE RATING: 335 VRMS
 INSULATION RESISTANCE: 5,000 MEGOHMS

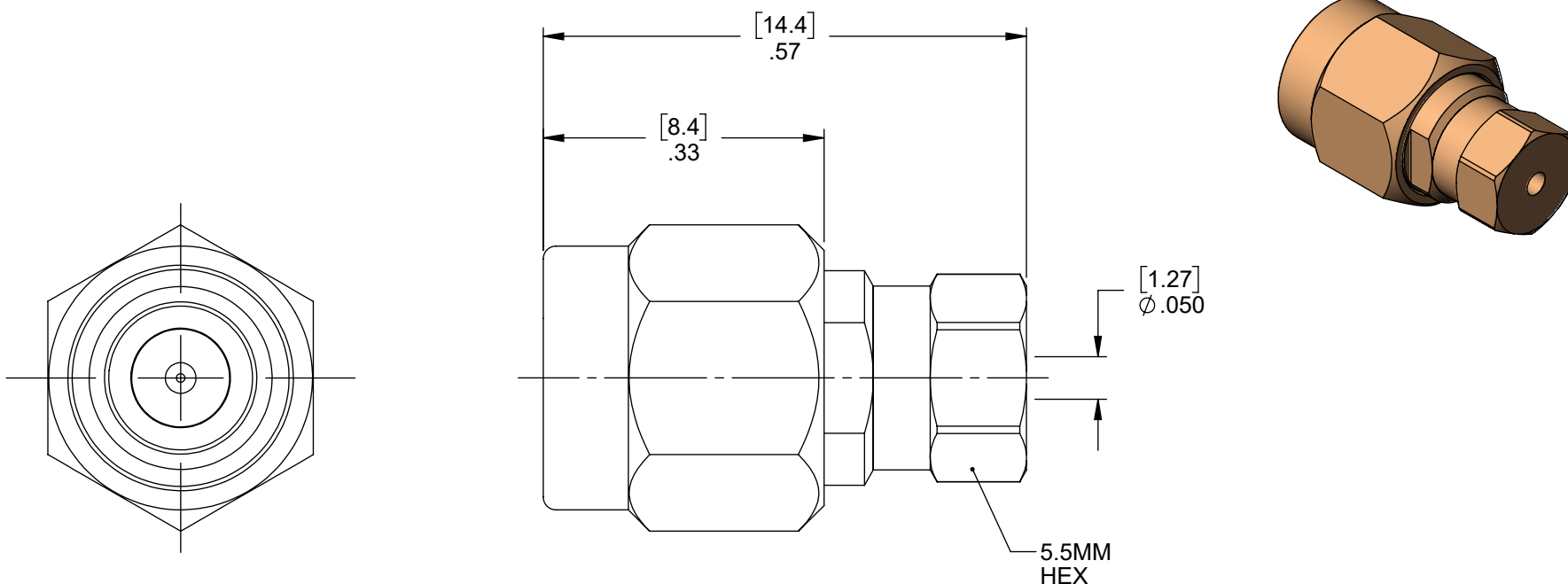

IntelliConnect

TITLE: SMA STRAIGHT CABLED SOLDERLESS PLUG (NON-MAGNETIC)

MATERIAL & FINISH: PER TABLE ABOVE

UNLESS OTHERWISE SPECIFIED

ALL DIMENSIONS ARE REFERENCE
 X.XXX DIM'S = INCHES * [X.XX] DIM'S = MILLIMETERS
 SURFACE FINISH: 63 MICRO MAX.
 ALL DIAMETERS TO BE CONCENTRIC WITHIN .005 F.I.M.

DRAWN BY: NB	CHECK BY: MS	APPR. BY: REP
DATE: 06/26/20	DATE: 06/26/20	DATE: 06/26/20

CAGE CODE NO: 5N5S5	SCALE: 5:1	SIZE: A	REV: A
----------------------------	-------------------	----------------	---------------

SALES DRAWING	PART NO. 5141-P1NN-611-101G	SHEET 1 OF 1
----------------------	---------------------------------------	------------------------

A	NPR 1760E	REP	06/26/20
REV	DESCRIPTION	APPR	DATE