

**MATERIAL/FINISH PROPERTIES**

**MATERIAL PROPERTIES:**

INTERFACE BODY: BERYLLIUM COPPER PER ASTM B196, HEAT TREATED TO H1, PER ES110  
 CABLE BODY: BRASS PER ASTM B16 OR EQUIVALENT  
 CENTER CONTACT: BERYLLIUM COPPER PER ASTM B196, HEAT TREATED TO H1, PER ES110  
 INSULATOR: PTFE PER ASTM D1710 OR EQUIVALENT  
 GASKETS: SILICONE RUBBER PER AA59588 OR EQUIVALENT

**PLATING PROPERTIES:**

INTERFACE BODY: .000040 MIN. GOLD PER MIL-G-45204 OVER  
 .000050 MIN. NICKEL PER QQ-N-290  
 CABLE BODY/CRIMP FERRULE: .000100 MIN. NICKEL PER QQ-N-290  
 CONTACT: .000040 MIN. GOLD PER MIL-G-45204 OVER  
 .000050 MIN. NICKEL PER QQ-N-290

**MECHANICAL/ELECTRICAL PROPERTIES**

CONNECTOR MEETS: RoHS 2002/95/EC STANDARDS  
 CONNECTOR DURABILITY: 3000 CYCLES MIN.  
 CABLE: RG178 OR EQUIVALENT  
 ASSEMBLY INSTRUCTIONS: AI416  
 IMPEDANCE: 50 OHMS NOMINAL  
 FREQUENCY RANGE: DC-1 GHz  
 VOLTAGE RATING: 335 VRMS  
 INSULATION RESISTANCE: 5,000 MEGOHMS  
 CONTACT RESISTANCE:  
 CENTER: 5.0 MILLIOHMS MAX.  
 OUTER: 1.0 MILLIOHMS MAX.

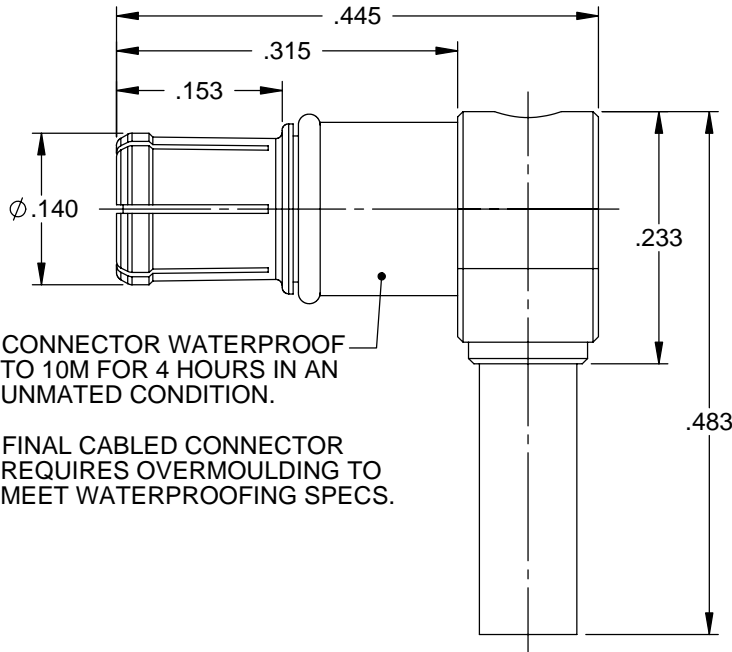

- CONNECTOR WATERPROOF TO 10M FOR 4 HOURS IN AN UNMATED CONDITION.
- FINAL CABLED CONNECTOR REQUIRES OVERMOULDING TO MEET WATERPROOFING SPECS.

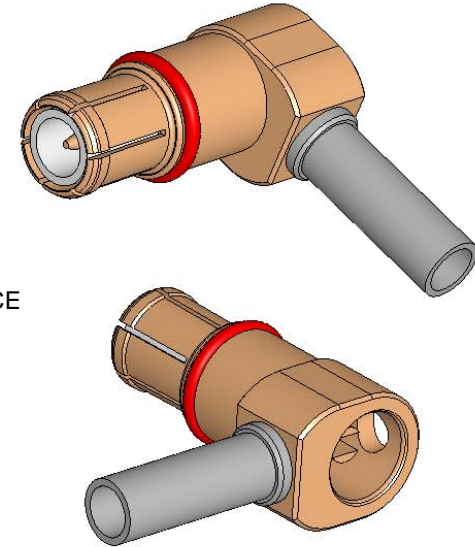
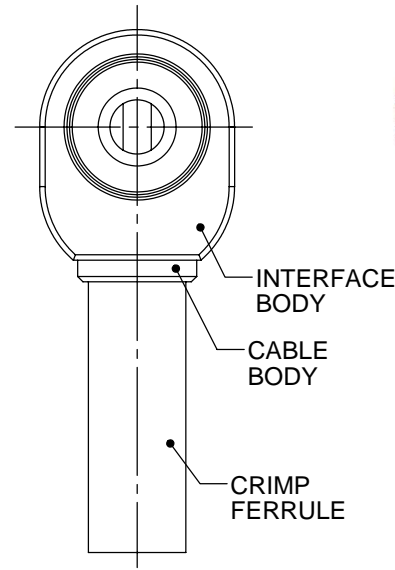

**IntelliConnect**

**UNLESS OTHERWISE SPECIFIED**

ALL DIMENSIONS ARE REFERENCE  
 X.XXX DIM'S = INCHES \* [X.XX] DIM'S = MILLIMETERS  
 SURFACE FINISH: 63 MICRO MAX.  
 ALL DIAMETERS TO BE CONCENTRIC WITHIN .005 F.I.M.

**TITLE:** ABMS SEALED RIGHT ANGLE CABLED PLUG

**MATERIAL & FINISH:** PER TABLE ABOVE

<b>DRAWN BY:</b> SRS	<b>CHECK BY:</b> PCS	<b>APPR. BY:</b> TLB
<b>DATE:</b> 05/04/12	<b>DATE:</b> 05/04/12	<b>DATE:</b> 05/04/12
<b>CAGE CODE NO:</b> 5N5S5	<b>SCALE:</b> 6:1	<b>SIZE:</b> A
<b>SALES DRAWING</b>	<b>PART NO.</b> 5171-P2NN-306-100Z	<b>REV</b> 1
		<b>SHEET</b> 1 OF 1

1	NPR 825E	TLB	05/04/12
<b>REV</b>	<b>DESCRIPTION</b>	<b>APPR</b>	<b>DATE</b>